

Plansa nr. 2 - Situatie existenta

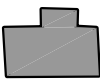

Constructii existente
Limite de proprietate

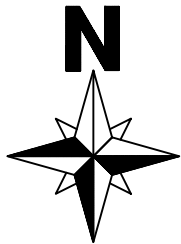

ELIPSOID: Krasovski
PROIECTIA: Stereografica 1970
SISTEM ALTIMETRIC: Marea Neagra 1975

CALCULUL ANALITIC AL SUPRAFETEI DE TEREN-
NUMAR CADASTRAL 139087

| NR CRT | DEN PUNCT CONT | COORDONATE | | LATURA [m] |
|-----------|----------------------|------------|------------|---------------|
| | | X[m] | Y[m] | |
| 1 | 1 | 381276.937 | 580886.623 | 3.743 |
| 2 | 14 | 381279.770 | 580889.070 | 26.956 |
| 3 | 15 | 381283.550 | 580915.760 | 4.188 |
| 4 | 16 | 381279.367 | 580915.959 | 5.354 |
| 5 | 17 | 381274.056 | 580915.285 | 4.805 |
| 6 | 18 | 381275.016 | 580910.577 | 9.821 |
| 7 | 19 | 381275.338 | 580900.761 | 4.550 |
| 8 | 20 | 381275.059 | 580896.220 | 6.795 |
| 9 | 21 | 381273.780 | 580889.546 | 2.568 |
| 10 | 2 | 381273.263 | 580887.031 | 15.115 |
| 11 | 3 | 381258.236 | 580888.658 | 6.804 |
| 12 | 4 | 381251.484 | 580889.494 | 1.863 |
| 13 | 5 | 381251.282 | 580887.642 | 10.175 |
| 14 | 6 | 381249.970 | 580877.552 | 1.478 |
| 15 | 7 | 381249.279 | 580876.246 | 3.387 |
| 16 | 8 | 381249.051 | 580872.867 | 1.022 |
| 17 | 9 | 381250.063 | 580872.722 | 9.908 |
| 18 | 10 | 381250.63 | 580872.048 | 0.744 |
| 19 | 11 | 381260.690 | 580871.994 | 12.162 |
| 20 | 12 | 381272.826 | 580871.203 | 2.594 |
| 21 | 13 | 381275.411 | 580870.986 | 15.711 |
| 1 | 1 | 381276.937 | 580886.623 | |

S = 421 mp

CALCULUL ANALITIC AL SUPRAFETEI DE TEREN-
SUPRAFATA DE STUDIU

| NR CRT | DEN PUNCT CONT | COORDONATE | | LATURA [m] |
|-----------|----------------------|------------|------------|---------------|
| | | X[m] | Y[m] | |
| 1 | 1 | 381276.937 | 580886.623 | 3.743 |
| 2 | 14 | 381279.770 | 580889.070 | 26.956 |
| 3 | 15 | 381283.550 | 580915.760 | 4.188 |
| 4 | 16 | 381279.367 | 580915.959 | 5.354 |
| 5 | 17 | 381274.056 | 580915.285 | 4.805 |
| 6 | 18 | 381275.016 | 580910.577 | 9.821 |
| 7 | 19 | 381275.338 | 580900.761 | 4.550 |
| 8 | 20 | 381275.059 | 580896.220 | 6.795 |
| 9 | 21 | 381273.780 | 580889.546 | 2.568 |
| 10 | 2 | 381273.263 | 580887.031 | 15.115 |
| 11 | 3 | 381258.236 | 580888.658 | 6.804 |
| 12 | 4 | 381251.484 | 580889.494 | 1.863 |
| 13 | 5 | 381251.282 | 580887.642 | 10.175 |
| 14 | 6 | 381249.970 | 580877.552 | 1.478 |
| 15 | 7 | 381249.279 | 580876.246 | 3.387 |
| 16 | 8 | 381249.051 | 580872.867 | 1.022 |
| 17 | 9 | 381250.063 | 580872.722 | 9.908 |
| 18 | 10 | 381250.63 | 580872.048 | 0.744 |
| 19 | 11 | 381260.690 | 580871.994 | 12.162 |
| 20 | 12 | 381272.826 | 580871.203 | 2.594 |
| 21 | 13 | 381275.411 | 580870.986 | 15.711 |
| 1 | 1 | 381276.937 | 580886.623 | |

S = 614 mp

SUPORT TOPOGRAFIC-
SCARA 1: 500

-INTRAVILAN-
Teritoriul:
Adresa:
Proprietar:

MUNICIPIUL PLOIESTI
Mun. Ploiesti, Intrarea Lacauti, Nr. 11, judetul Prahova
1. Jujan Petre ,
2. Jujan Gheorghita,
3. Mihailescu Teodor-Razvan
4. Mihailescu Mirela
5. Gradinaru Eugen-Sebastian
6. Mihailescu Alexandra Ana,
7. Mihailescu Liviu
8. Mihailescu Sofia

Supr. teren studiata: S = 614 mp din care S = 421 mp nr.cadastral 139087,S=193mp Intrarea Lacauti,
-NR.CADASTRAL PROVIZORIU AL
CORPULUI DE PROPRIETATE: 139087

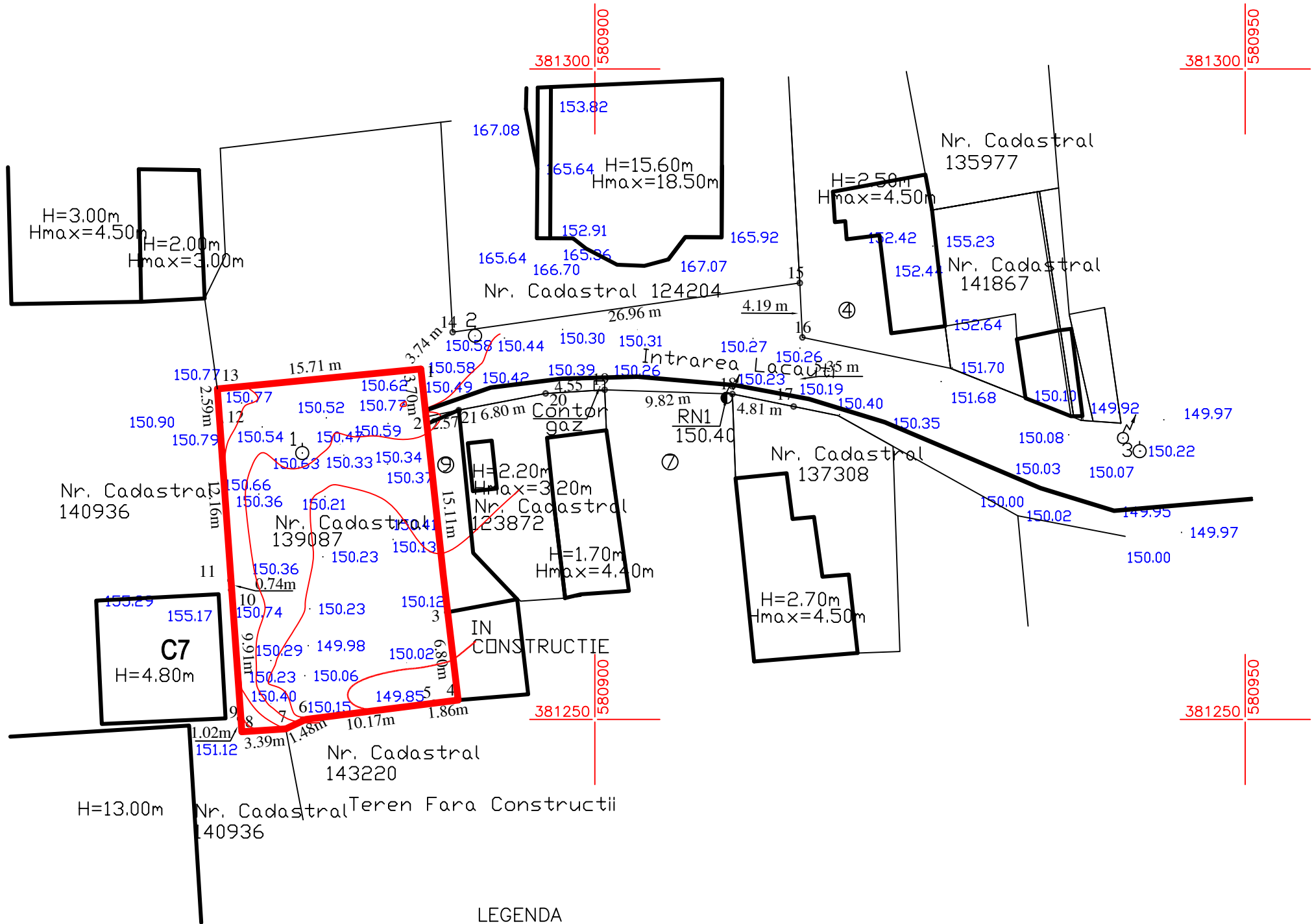

LEGENDA

- gard de beton
- gard metal
- gard plasa
- stalp el. beton
- statie topo

R.N.1
STALP ELECTRIC

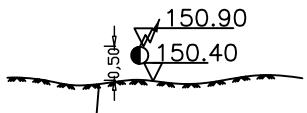

NOTA:

*Intocmit conform 453/2001 si 350/2001 precum si
a normelor A.N.C.P.I. in vigoare -ordinul 700/2014

| | | | | | |
|--|--------------------------|-------------------------|---|--|-------------|
| Rev/Nr. Cod fisa modificare | Data | | | | |
| Proiectat | arh/urb Danut Constantin | Specialitatea: URBANISM | Adresa obiectiv: Mun. Ploiesti, Intrarea Lacauti, Nr. 11, JUD. PRAHOVA | | |
| Verificat | | | | | |
| Aprobat | arh. Daniela Lazar | Data: mai 2019 | | | |
| Denumire proiect: Plan Urbanistic Zonal (PUZ) | | | SITUATIA EXISTENTA | | |
| LAZAR C. ELENA - DANIELA BIROU INDIVIDUAL DE ARHITECTURA | | Scara: 1/500 | Beneficiar: dl. MIHAILESCU TEODOR RAZVAN | | A2 |
| PROIECTAT: AERIAL CAD SOLUTIONS S.R.L. Autorizatie A.N.C.P.I. clasa III Seria RO-B-J nr.1205 mobil0724291835 tel:0244/241227 | | | BENEFICIARI: Jujan Petre, Jujan Gheorghita, Mihailescu Teodor Razvan, Mihailescu Mirela, Gradinaru Eugen Sebastian, Mihailescu Alexandra Ana, Mihailescu Liviu, Mihailescu Sofia | | PLANSA: 1/1 |
| AUTORIZAT O.C.P.I.: ing. Cojocaru Adrian | | DATA 02.2018 | OBIECT: SUPORT TOPOGRAFIC Obtinere Certificat de Urbanism | | |
| AUTORIZATIA: CATEGORIA B SERIA:RO-PH-F;NR.0136 | | SCARA 1:500 | Amplasament: Mun. Ploiesti, Intrarea Lacauti, Nr. 11, JUD. PRAHOVA | | |
| SEMNATURA : | | | SISTEM DE PROIECTIE: STEREOFRAFIC 1970 PLAN DE REFERINTA : MAREA NEAGRA 1975 | | |